

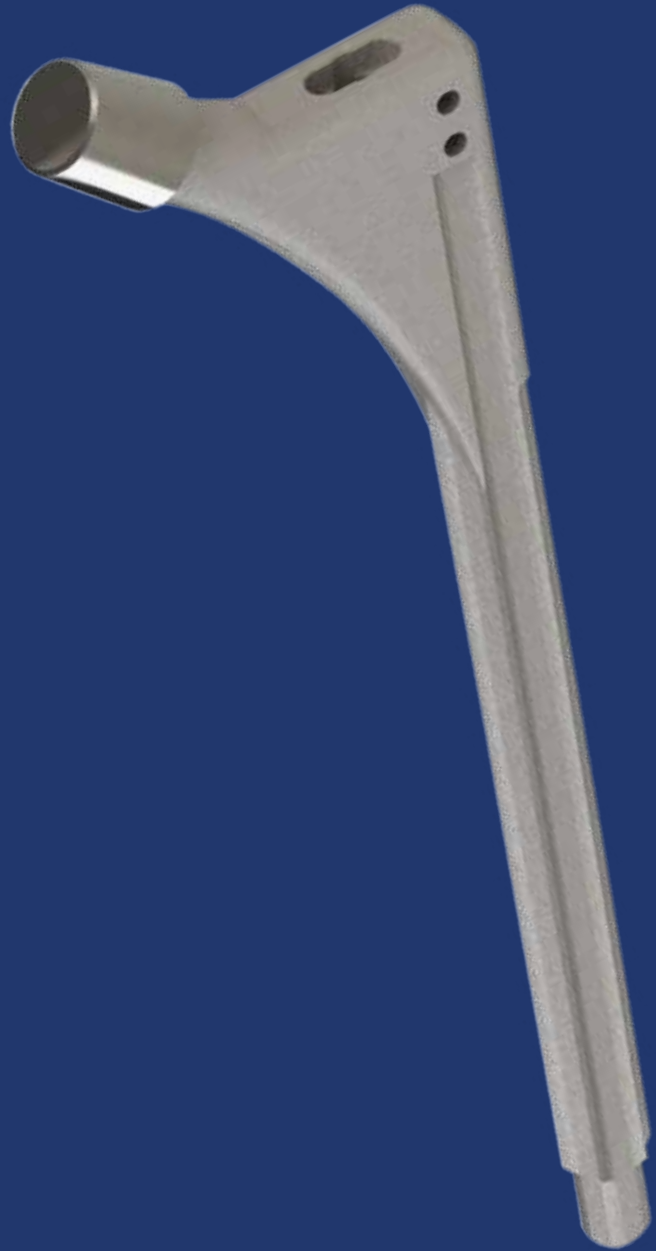

INDUS

JOINT REPLACEMENT SOLUTIONS



CE Certified Primary And Revision
Hip Replacement Systems



Indus Total Hip Replacement System

Acetabular Cup

316L Stainless Steel

- Acetabular Cup made from UHMWPE, imported from Orthoplastics U.K. with grooves for better fixation with cement
- 15 degree hood to prevent posterior dislocation



Acetabular Cup
44 mm - 60 mm
(2mm increments)

Long Revision Stem

CoCr stem Corundum blasted (for increased osseous integration) for Cementless fixation

- Unique Osteophilic Design
- 5 longitudinal ribs with relatively sharp ridges, intended to engage the femoral cortex, thus enabling bony apposition and optimum rotational stability
- 12/14 taper enabling versatility in femoral head choice
- Indicated in primary / revision case with proximal defect; where distal fixation is required

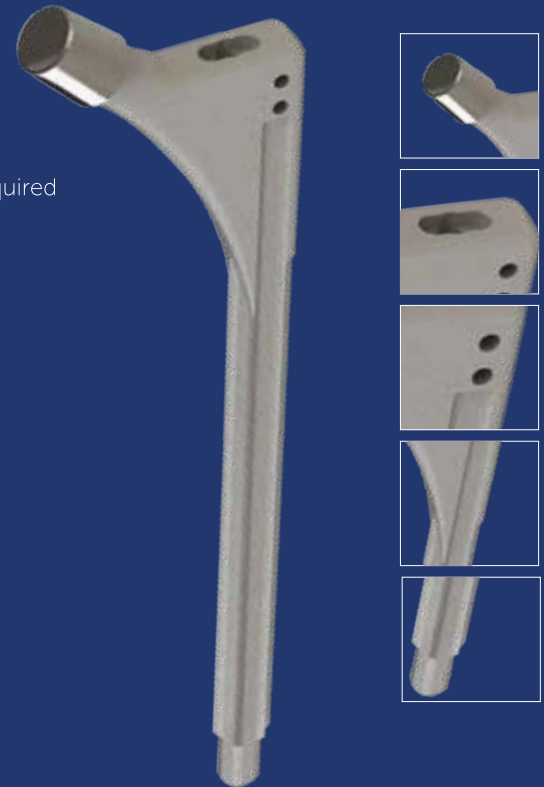

Stem Specifications

Stem Size	Neck length	Neck shaft angle	Head offset	Stem length
12mmx200L	44	135	40	200
12mmx250L	44	135	40	250
14mmx200L	43	135	40	200
14mmx250L	43	135	40	250
16mmx200L	43	135	39	200
16mmx250L	43	135	39	250

(mm)

Bipolar Head

316L Stainless Steel Modular system, highly polished outer surface, the polyethylene used is UHMWPE from UK

- Self-Centering design (second generation) that offers greater range of motion without risks of dislocation or impingement
- Highly polished outer surface for smooth, frictionless movement

Size options: OD: 39 mm - 43 mm at interval of 2 mm
Internal Head option: 22.2 mm (-4,0,+4)

OD: 45 mm - 53 mm at interval of 2 mm
Internal Head option: 28 mm (-4,0,+4,+8)



Unipolar Head / SMP HEAD

316L Stainless Steel

- Highly polished outer surface for smooth, frictionless movement
- Can be used with all variants of stems with 12/14 neck taper
- To be used for hemiarthroplasty in elderly population with minimal range of movement requirements

Size options: 39 mm to 53 mm at intervals of 2 mm

